

DestinationImagiNation®

Creativity ★ Teamwork ★ Problem Solving



Louisiana 2012 State Tournament



Our Sponsors



Our Partners



Our Local Supporters

Elm Grove Middle School

Bossier Parish Schools

Bossier High School NHS

Parkway High School Baseball, ASTRA & Beta Clubs



A special thank you to Mrs. Terrie Johnson, Principal; Mr. Ross Boyett and Mrs. Darlene Barnhill, Assistant Principals; Coach Mark Tabor, Concessions, Mr. Bobby Moton, Custodian, Mrs. Ashley Richey, DI Coordinator; and Elm Grove Middle School staff for hosting this event. Thanks also to our team managers, appraisers, officials and other volunteers.

Team Challenge performances—audiences are welcome! Enjoy food & drinks at the Boys' Gym concession stand.

Instant Challenges are held in the C-Wing of Elm Grove Middle School. Teams need to check in **15 minutes** before their Instant Challenge time. This area is closed to the public throughout the day--no audience is allowed. Instant challenges must be kept secret until after Global Finals, May 26, 2012.

As guests of Elm Grove Middle School, please treat the facilities with care and respect by cleaning up your areas.



**Staff
Parking**

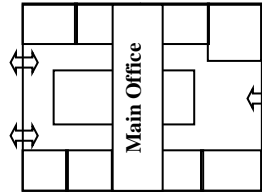
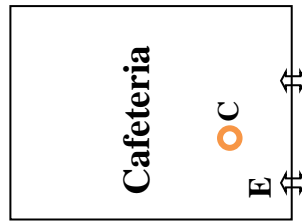
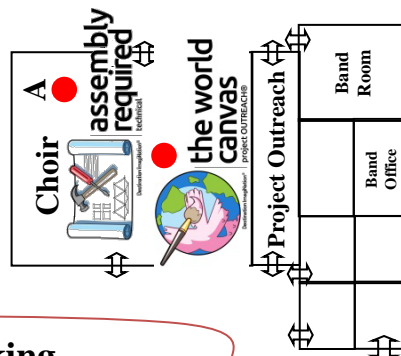
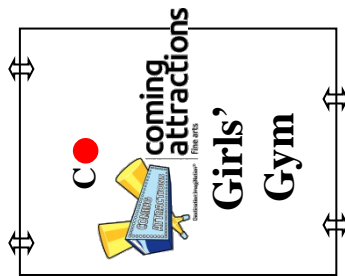
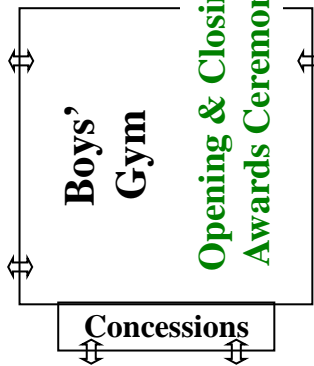

DI Store
10:00-5:30

Public Parking

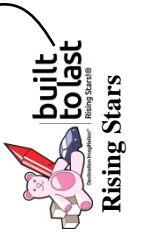
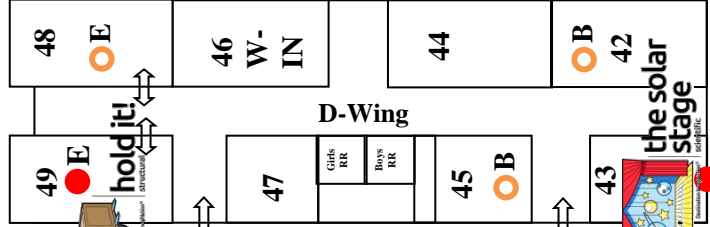
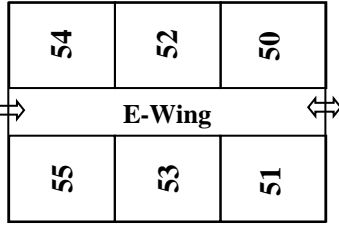
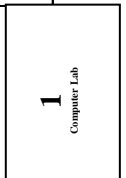
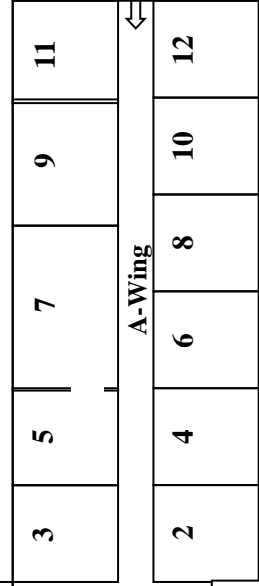
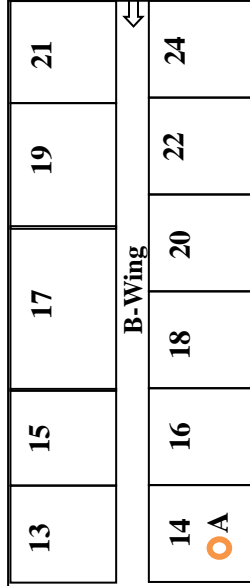
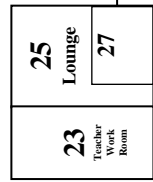
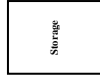
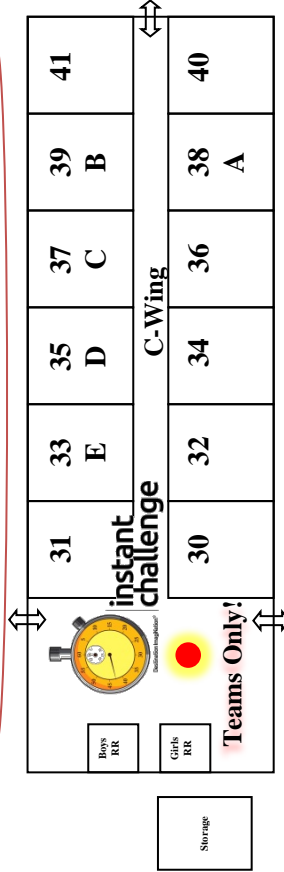

Elm Grove Middle School

- = Performance Location
- = Prop Storage (Teams Only)
- ↕ = Entry/Exit Door

Public Parking

Public Parking

LA D.I. State Tournament Schedule

Saturday, March 10, 2012, 8:30 AM--Opening ceremony in Elm Grove MS Boys' Gym

Visit Louisiana Destination ImagiNation at ladeest.com

Challenge	Performance Time		Instant Challenge			
A: Assembly Required (Choir Room)			Check-in	Instant Ch. C Wing		
Ethel Schoeffner ML	118-83823	9:40	1:15	1:30	Rm B	
Cope ML	118-81447	10:10	1:45	2:00	Rm B	
Elm Grove ML	118-92068	10:40	2:15	2:30	Rm B	
Curtis EL	118-32003	11:10	12:45	1:00	Rm E	
Parkway SL	118-06764	11:40	9:00	9:15	Rm D	
Airline SL	118-67796	12:10	9:30	9:45	Rm D	
B: The Solar Stage (D-Wing, Rm 43)			Performance		Instant Challenge	
Stockwell EL	118-48143	1:00	9:00	9:15	Rm C	
Sun City EL	118-59786	1:30	9:30	9:45	Rm C	
Meadowview EL	118-64105	2:00	10:00	10:15	Rm C	
Curtis EL	118-38271	2:30	10:30	10:45	Rm C	
Parkway SL	118-09509	3:00	11:00	11:15	Rm C	
C: Coming Attractions (Girls' Gym)			Performance		Instant Challenge	
Curtis EL	118-39445	9:20	10:15	10:30	Rm D	
Bellaire EL	118-30547	9:40	10:45	11:00	Rm D	
Arthur Circle EL	118-06245	10:00	11:15	11:30	Rm D	
Elm Grove EL	118-81057	10:20	11:45	12:00	Rm D	
First Baptist EL	118-92802	10:40	12:15	12:30	Rm D	
Meadowview EL	118-70330	11:00	12:45	1:00	Rm D	
St Marks Cathedral EL	118-39482	11:20	1:15	1:30	Rm D	
Stockwell EL	118-48731	11:40	1:45	2:00	Rm D	
Sun City EL	118-62521	12:00	2:15	2:30	Rm D	
Elm Grove ML	118-95402	1:20	9:00	9:15	Rm B	
Ethel Schoeffner ML	118-48183	1:40	9:30	9:45	Rm B	
Cope ML	118-82094	2:00	10:00	10:15	Rm B	
Haughton ML	118-40851	2:20	10:30	10:45	Rm B	
Airline SL	118-05415	2:40	10:30	10:45	Rm A	
S. Terrebonne SL	118-60914	3:00	11:00	11:15	Rm A	
Parkway Team 1 SL	118-12549	3:20	11:30	11:45	Rm A	
Parkway Team 2 SL	118-12661	3:40	12:00	12:15	Rm A	
LA Tech UL	118-85743	4:00	12:45	1:00	Rm C	
D: News to Me (Library)			Check-In	Performance	Instant Challenge	
Haughton ML	118-34030	9:30	9:45	11:45	12:00	Rm B
Elm Grove ML	118-28299	10:00	10:15	12:15	12:30	Rm B
Cope ML	118-84295	10:30	10:45	12:45	1:00	Rm B
Airline SL	118-67936	11:00	11:15	9:00	9:15	Rm A
S. Terrebonne SL	118-66038	11:30	11:45	9:30	9:45	Rm A
Parkway SL	118-16969	12:00	12:15	10:00	10:15	Rm A
Bellaire EL	118-31226	1:15	1:30	10:15	10:30	Rm E
Curtis EL	118-53415	1:45	2:00	10:45	11:00	Rm E
Stockwell EL	118-50979	2:15	2:30	11:15	11:30	Rm E
E: Hold It! (D-Wing, Room 49)			Weigh-In	Performance	Instant Challenge	
Curtis EL	118-62855	9:30	10:00	1:15	1:30	Rm E
Ethel Schoeffner ML	118-04036	10:00	10:30	1:00	1:15	Rm A
Haughton ML	118-44732	10:30	11:00	1:30	1:45	Rm A
Cope ML	118-86684	11:00	11:30	2:00	2:15	Rm A
Elm Grove ML	118-74317	11:30	12:00	2:30	2:45	Rm A
Parkway SL	118-18804	12:30	1:00	1:45	2:00	Rm C
Rising Stars (D-Wing Room 43)			Performance		Instant Challenge	
Elm Grove EL	118-49898	12:00	9:00	9:15	Rm E	
Bellaire EL	118-08378	12:30	9:30	9:45	Rm E	
Project Outreach (Choir Room)			Performance		Instant Challenge	
Cope ML	118-87875	1:00	2:15	2:30	Rm C	

Duct Tape and Newspaper Costume Contest at 5:00 PM; Awards ceremony Boys' Gym at 5:30 PM

Louisiana Destination ImagiNation Volunteers



Affiliate Director: Nancy Farley
Affiliate Training Director: Joan Turek



Challenge Masters
Samantha Hano Dale Farley JoAnna Greer Mona Oliver
Jimmie Ray Joydeep Bhattacharjee

Score Master: Nadean Tanner
Web Master/Photographer: Ray Turek
Appraiser/Official Support: Karen Walters

Appraisers and Officials

Yvonne Barrier
Emily Bartlett
Dennis Bell
Amy Bellotte
Zac Burson
John Carr
Heidi Chapman
Ashley Chappel
Nikki Chisolm
Kellee Churchwell
Lisa Cole
Rick Copes
Elizabeth Davis
Jaime Davis
Brandon Dilda
Valerie Ducharme
Susan Eller
Andi Finnimore

Josh Gaston
Juli Gilbert
Elaine Harner
Theresa Hernandez
Jeff Holcomb
Garrett Jennings
Jacob Kelley
Ian Kolb
Marlena Koper
Angela Leachman
Casy Leatherman
Mara Loeb
Vicki Lynch
Vicky Lynch
Melissa Mainiero
Saswati Majumdar
Cesar Marrero
Melinda Matthews

Ann McMillian
Phil McMillian
Trevor Melder
Lynn Milner
Delilah Montero
Hannah Morris
Kathrin Munding
Linda Munding
Jan O'Brien
Lacey O'Brien
Jesse Oliver
Courtney Ray
Matthew Reid
Marco Reyes
Alan Ringle
Michele Ringle
Gail Rittenberry
Mary Seale

Shannon Shea
Alicia Schillerstrom
C. Turner Streckline
Brian Sullivan
Rachel Sullivan
Kenneth Tanner
Susan Thomas
Ryan Turek
Natasha Van Der Merwe
Aerin Walters
Terry Walters
Lynn Watson
Jim Watson
Jan Webb
Anita White
Rebekah White

4:30 All props **must be** removed from prop rooms and rooms must be cleaned

5:00 Duct tape and newspaper costume contest in Boys' Gym

5:30 Awards Ceremony in Elm Grove MS Boys' Gym

Team managers of all Global Finals Qualified Teams see Nancy Farley, Affiliate Director, to discuss Global Finals immediately after the closing ceremony.

Global Finals Qualified Teams: Notify Mrs. Farley if you plan to attend Global Finals by Friday, March 16.

Pins and other DI items may be purchased at the DI Store outside the Library. Pins are traded at Global Finals and will be available for purchase until 30 minutes after awards.

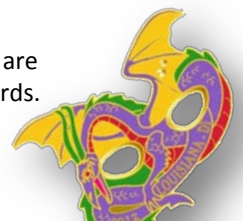

Legal Notice:

By participation in an event conducted by an Affiliate, Region or other gathering related to the Destination Imagination program, the participant and/or participant's parents and/or participant's guardian understands and hereby voluntarily agrees to release, waive, forever discharge, hold harmless, defend and indemnify Destination Imagination Inc., and Bossier Parish School Board, their agents, officers, boards, volunteers, and employees from any and all liability and all claims, actions, or losses for bodily injury, property damage, wrongful death, loss of services, or otherwise which may arise out of the participant's participation in activities related to the Destination Imagination event, including travel to and from the event.